

# InnovaTech IMP WallCart

## PRODUCT USER GUIDE

IWC-15



## Safety

- Be alert during configuration to avoid crush and pinch hazards.
- Secure load to the WallCart using the D-Rings provided.
- Use a spotter during transport to prevent damage to WallCart, load, or other items.
- Drive slowly to maintain control.

## Overview

The InnovaTech IMP WallCart is designed to be managed by a telehandler and carry Insulated Metal Panel (IMP) Walls that are too small for the WallMaster to carry. Its purpose is to take these smaller walls from the fabrication area to the installation area where they will be tilted up by a crane directly off the WallCart.

## Product Use

### A. Assembly

1. Align side rails to mainframe ams.
2. Secure with fasteners as specified above.

### B. Inspect WallCart before each shift. Inspect for the following:

1. Tires: wear, air pressure
2. Frame: weld joints, bolted connections
3. Telehandler Connection: weld joints
4. Landing Gear: general condition
5. Tie-Down D-Rings: general condition
6. Labels and Markings: general condition

### C. Telehandler Connection and WallCart Use

1. Connect Telehandler to telehandler lift point.
2. Lift the telehandler end of the WallCart for ground clearance.
3. Maneuver the WallCart under the panelized IMP wall.
4. Lower wall onto the WallCart.
5. Maneuver the loaded WallCart to the staging or hoisting area.
6. Connect hoist rigging to the wall and tilt wall directly from the WallCart.

### D. Transport and Storage

The WallCart is transported to the jobsite with two side rails disconnected and loaded atop the main assembly.

Store WallCart away from caustic environments.

## Specifications

### Dimensions

Length .....	59 ft 8 in
Transport Width.....	9 ft 0 in
Working Width.....	12 ft 0 in
Height.....	40.25 in
Highest Point.....	100.25 in

### Weight and Capacity

Empty Weight (EW) .....	14,040 lbs
Max Full Weight (FW) .....	29,040 lbs
Capacity.....	15,000 lbs

### Tire Specs

Size .....	255/70R22.5, Load Range H
Max Load .....	5,070 @ 120 psi
Lug Nut Torque.....	450 ft-lbs

### Lube

Grease .....	High-Viscosity Grease
Hub Oil .....	75-90 Synthetic Gear Lube or Lucas Hub Oil

### Fasteners

Note: (All fasteners Zinc Yellow Chrome Plated)

Side Rail to Main Frame

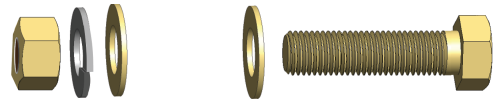

Grade 8 Heavy Hex Bolt .....	3/4 - 3 x 10 in
Two Oversized Flat Washers .....	
Split Lock Washer .....	
Hex Nut .....	
Torque .....	315 ft-lbs

Innovatech Manufacturing  
4360 N WECCO Rd  
Cedar City, UT 84721  
<https://innova.tech>

**INNOVATECH**  
ENGINEERED TO DO MORE.

**IWC-15**

IWC15-PUG01-R00

# Maintenance

---

## 50-hour Service

1. Lube: Check hub oil, refill as needed. Grease telehandler connection pedestal bearings. Grease Landing Gear as needed.
2. Torque: Check lug nut torque.
3. Labels and Decals: Replace damaged or missing labels and decals.

Do not modify this product without written permission from InnovaTech Manufacturing.

## Revision Log

---

Produced by: InnovaTech Manufacturing  
Product: IMP WallCart Product Use and Safety  
Manual Product Code: IWC15-PUG01-R00  
Version: First Production  
Production Date: May 31, 2023

This document is intended as a basic source of information on the safe use and maintenance of InnovaTech Manufacturing's IMP WallCart. This document provides general information as well as specific warnings, instructions, and information that users of this product must read, understand, and follow.

This document is not intended as an all-encompassing safety "rule." Instead, InnovaTech Manufacturing presents this information as a reference and guide only. It is the purchaser's and user's responsibility to identify specific safety hazards and determine proper procedures to prevent those hazards from inflicting injury.

Safety is paramount in the use of this product. A copy of this guide should be made available to all persons using this product. This guide is available online at <https://innova.tech>.

All information in this document is based on the latest product information at the time of publication. However, there may be design improvements from time to time so that photographs, text, and sketches in this document may not exactly match your product. InnovaTech Manufacturing's responsibility, financial or otherwise, for any consequences arising out of the use of this document or product is limited by our product warranty. The information contained herein is subject to change, and revisions may be issued to advise of such changes. InnovaTech reserves the right to make product changes at any time without obligation.

This document contains subject matter to which InnovaTech Manufacturing has proprietary rights. Recipients of this

document shall not duplicate, use, or disclose information contained herein, in whole or in part, for any use other than training personnel on safe use and maintenance of this product.

If you have any questions or concerns about the content of this service and maintenance guide or, if you would like to request updated information, we want to hear from you.

Please contact us:

<https://innova.tech>

[support@innova.tech](mailto:support@innova.tech)

INNOVATECH MANUFACTURING  
TECHNICAL PUBLICATIONS  
4360 N WECCO RD  
CEDAR CITY, UT, USA 84721

The InnovaTech IMP WallCart is protected under US Patent Pending.

©2023 InnovaTech Manufacturing. All Rights Reserved.